

vista



style &
simplicity

Somerset Railing Kit System



Somerset Railing Kit System

- ✔ **All-In-One Kit**
Everything you need between the posts!
- ✔ **Ease of Installation**
Factory precision pre-drilled rails speed up and simplify installation.
- ✔ **Cost Effective**
Installs in half the time of alternative component systems saving time, money and frustration.
- ✔ **Low Maintenance**
Powder-coated balusters that never require painting or staining and never rot, twist or split.
- ✔ **Safety Assured**
Tested in accordance with national building codes.

Vista Railing Systems Inc.
www.vistarailings.com or 800-667-8247



vista

style & simplicity

Somerset Railing Kit System

Somerset Railing Kit System

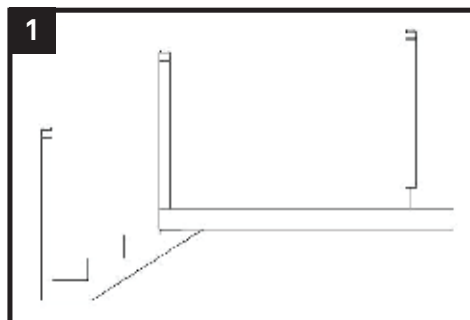

1 Set newel posts (sold separately) to accommodate pre-drilled rail length. Center pre-drilled rail between newel posts and trim equal amounts from each end of top and bottom rails.

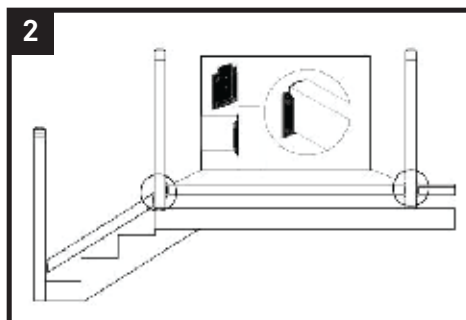

2 Slide rail hanger bracket over the end of the rail and attach with screws through end of rail. (Hint: Opening of bracket must always be up).

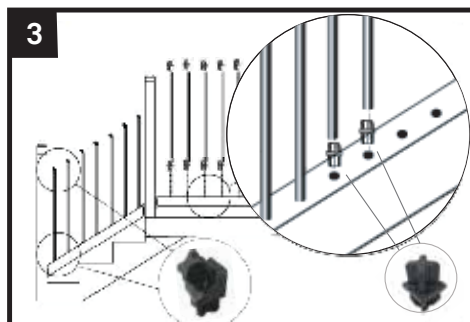

3 With a high-quality polyurethane construction adhesive, fill all the holes half way. Insert balusters with adapters into pre-drilled holes in rail. This will bond the wood to the balusters.

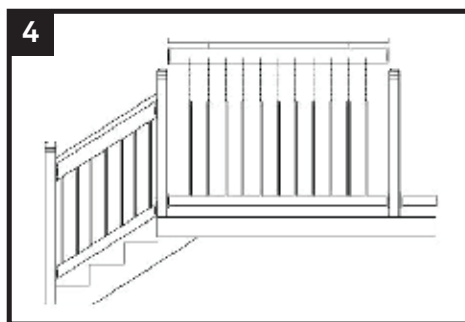

4 Apply pre-drilled top rail. Attach cap rail. Fasten railing section to posts with rail hanger brackets.

EVERYTHING YOU NEED BETWEEN THE POSTS!

- ✔ 2 factory pre-drilled rails
- ✔ 1 cap rail
- ✔ Powder-coated balusters (square/straight)
- ✔ Level kits include 30 baluster adapters
- ✔ Stair kits include 30 angle baluster adapters
- ✔ 2 pairs of rail hanger brackets with fasteners

LEVEL	STAIR	
6 ft Kit 42" 3 Rail Brown Treated – SRBTR6B32M 6 ft Kit 42" 3 Rail Premium Western Red Cedar – SRWRC6B32M	6 ft Stair Kit 36" 3 Rail Brown Treated – SSBTR6B26M 6 ft Stair Kit 36" 3 Rail Premium Western Red Cedar – SSWRC6B26M	Rail Hanger Bracket (Pack of 2 with fasteners) HW9509600W



WRC: CE9106054W
BT: BT9106054U

Note: Contact your local building department prior to installation. Level & Stair Kits available in Premium Western Red Cedar (WRC) and Brown Treated (BT). Posts also available for purchase in Premium Western Red Cedar (WRC) or Brown Treated (BT) options (posts not included in kit). Level kits available in 42" height only.