

Clearview Railing Kit System



Clearview Railing Kit System

- ✔ **Quick and Easy**
A two-box system with tempered glass panels in one box and pre-slotted rails and brackets in another box.
- ✔ **Ease of Installation**
Factory precision pre-slotted rails speed up and simplify installation.
- ✔ **Cost Effective**
Installs in half the time of alternative component systems saving time, money and frustration.
- ✔ **Beautiful Craftsmanship**
Design provides a clean and contemporary look with unobstructed views.
- ✔ **Safety Assured**
Tested in accordance with national building codes.



vista

style &
simplicity

Clearview Railing Kit System

Clearview Railing Kit System

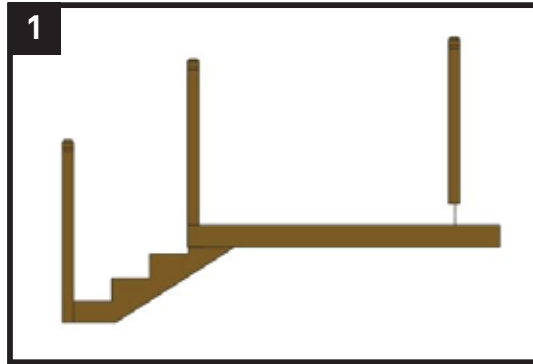

1 Install newel posts (sold separately)

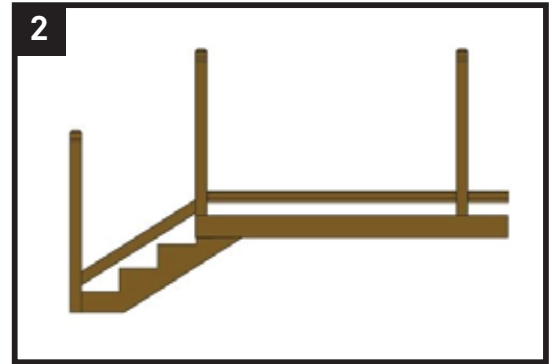

2 Install bottom rail

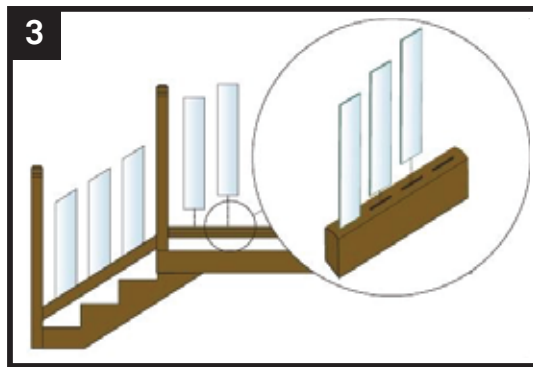

3 Install glass panels

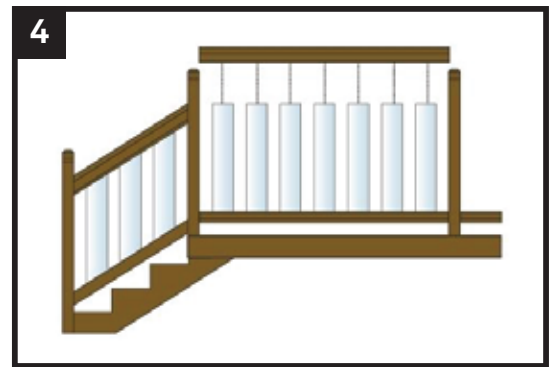

4 Install top rail

PREMIUM CLEARVIEW DECK RAILING KITS (2 PC PKG)

- ✔ 2 pre-slotted rails
- ✔ 1 cap rail
- ✔ 2 pairs of rail hanger brackets with fasteners

- ✔ Glass Package includes:
 - 5/16" clear tempered glass panels
 - Available in 36" or 42" deck railing height

CLEARVIEW GLASS PANELS (1 CARTON)	RAILING KITS	
5/16" x 6" x 26 1/4" Clear Tempered Glass Panel (for 36" railing height) – GL9000C26W	6 ft Premium Western Red Cedar Deck Railing Kit (3 rail pieces – 7 slots) – CVWRCCP06I	 Rail Hanger Bracket Pack of 2 with fasteners HW9509600W
5/16" x 6" x 32 1/4" Clear Tempered Glass Panel (for 42" railing height) – GL9000C32W	6 ft Premium Western Red Cedar Stair Railing Kit (3 rail pieces – 6 slots) – CVWRCCS06I	
5/16" x 6" x 33 1/2" Clear Tempered Glass Panel (for stair railing) – GL9000C33H		



Note: Contact your local building department prior to installation. Available in Premium Western Red Cedar. Kits come in Level and Stair options. Glass and railing sold separately. Posts also available for purchase in Premium Western Red Cedar (posts not included in kit). Available in 36" and 42" railing height.