

Somerset Railing Kit System

vista 
style &
simplicity



Somerset Railing Kit System

- ✔ **All-In-One Kit**
Everything you need between the posts!
- ✔ **Ease of Installation**
Factory precision pre-drilled rails speed up and simplify installation.
- ✔ **Cost Effective**
Installs in half the time of alternative component systems saving time, money and frustration.
- ✔ **Low Maintenance**
Powder-coated square balusters that never require painting or staining and never rot, twist or split.
- ✔ **Safety Assured**
Tested in accordance with national building codes.

Vista Railing Systems Inc.
www.vistarailings.com or 800-667-8247

vista

style & simplicity

Somerset Railing Kit System

Somerset Railing Kit System

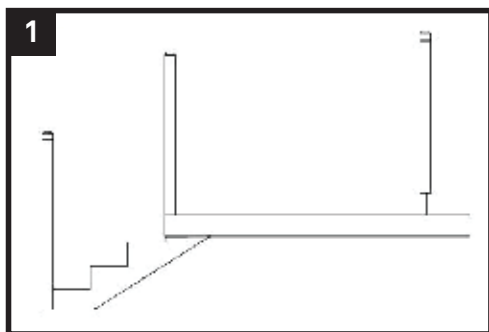

1 Set newel posts (sold separately) to accommodate pre-drilled rail length. Center pre-drilled rail between newel posts and trim equal amounts from each end of top and bottom rails.

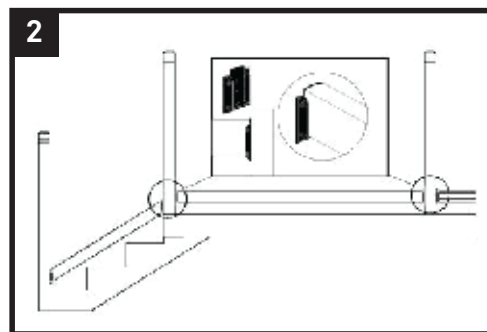

2 Slide rail hanger bracket over the end of the rail and attach with screws through end of rail (Hint: Opening of bracket must always be up).

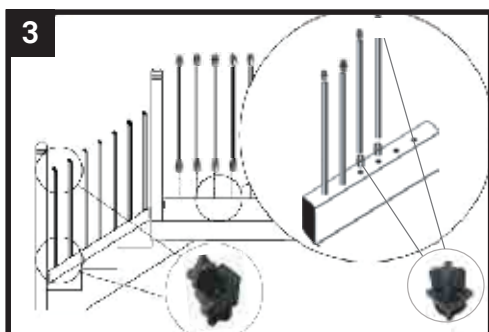

3 With a high-quality polyurethane construction adhesive, fill all the holes half way. Insert balusters with adapters into pre-drilled holes in rail. This will bond the wood to the balusters.

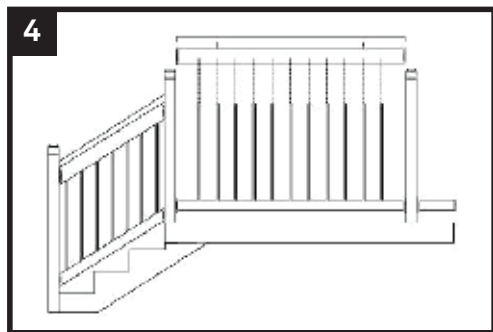

4 Attach pre-drilled top rail, fasten railing section to post with rail hanger bracket, attach cap rail with high-quality construction adhesive.

EVERYTHING YOU NEED BETWEEN THE POSTS!

- ✔ 2 profiled and factory pre-drilled rails
- ✔ 1 cap rail
- ✔ Square 3/4" powered-coated balusters
- ✔ 30 balusters to rail connectors
- ✔ 2 pairs of rail hanger brackets with fasteners



6ft Kit 32" 3 rail Premium Western Red Cedar – SRWRC6B32M



6ft Stair Kit (36°) 27" 3 rail Premium Western Red Cedar – SSWRC6B26M



RAIL HANGER BRACKET Pack of 2 with fasteners HW9509600W



Note: Check with the local building department as local building codes and bylaws may apply. Level & stair kits available in Premium Western Red Cedar. Posts also available for purchase in Premium Western Red Cedar (posts not included in kits). Level kits available in 42" railing height only.